

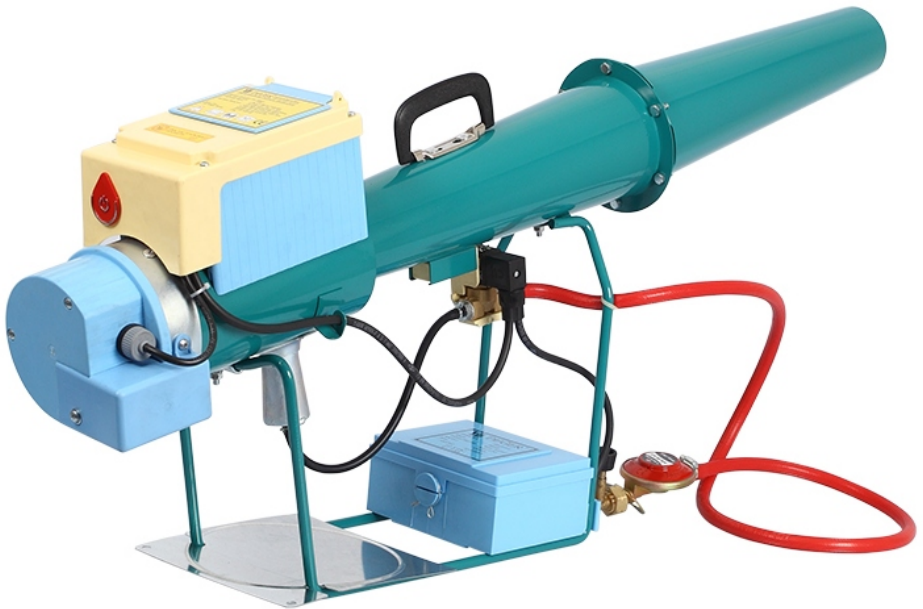

ELECTRONIC BIRD SCARER

#10750



USER GUIDE

Also available:
#10751 Tripod Stand



USER GUIDE AND INSTRUCTIONS FOR SAFE USAGE

FUNCTION OF THE BIRD SCARER:

This device uses LPG to produce explosive reports of 120dB, the frequency of which can be varied using the electronic timer.

APPLICATIONS:

- *In all kinds of crops including fruit and vegetables to deter birds and animals.
- *In fish farms to deter herons, cormorants, and other predators.
- *In airports to minimize bird strikes.
- *In chicken and other farms to deter birds.
- *In the feed factories and stores to deter birds.

INSTRUCTIONS FOR SAFE USAGE!



before using your device,
read the instructions and the user guide.
Please keep this information.

High sound level! Use ear-plugs!



Do not use in populated areas.



Put the device on a solid platform of
sheet iron, concrete or wood which is
at least 40 cm wide and 60 cm long.

Clear an area of one square meter
behind the device.



If you are unable to put the device on
a platform, put the device
in the center of a field
cleared of grass and other vegetation.



During the first use and time
adjustment stand behind the
device as in the illustration.
Do not forget to use ear plugs.

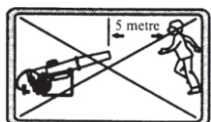

While the device is working
do not approach the front of
the device.

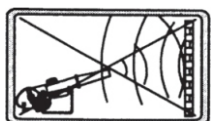

Do not place your cannon
close to wall, door etc.
as illustrated.
Because of sound waves can
echo and ears can be injured.



Do not use the device indoor.



Do not hang the device on a tree.



Do not cover the device with cloth
that touches the device. The device is
not affected by rain.

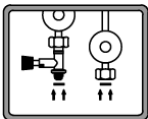

Be sure there is a gasket
in the fine adjustment valve and
that it is not damaged.
Replace gasket showing signs
of damage.

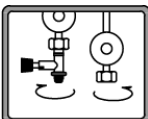

Check that the fine adjustment valve
or pressure regulator is tightly
screwed to the LPG cylinder.



Do not allow the device to be used by
a third party unless they have the
user guide and instructions for safe
usage.



Dispose of old devices
responsibly, and according to
local legislation regarding
recycling

ASSEMBLY :

- 1-Mount the front part of barrel (No.1).
- 2-Screw the fitting nut (No.5) to LPG tube tightly and open the main valve of LPG tube.
- 3-**Pay attention to colors of battery connections.**
Red is always for + pole.

AFTER USING:

- 1-Press the main power button to turn off the electricity.
- 2-Turn off the main valve of LPG tube.
- 3-Remove pressure regulator from LPG cylinder.

RECHARGING THE BATTERY (12V):

- *Battery level is low if the "batt" signal on the display is blinking.
- *Battery level is not enough to operate if "batt" signal on display is solid.

- 1-Remove the battery connection.
- 2-Connect the socket (crocodile) to charger (Picture-2).
Please see charge voltage of charger!
It must be 12V! (Picture-1)
- 3-Full charging time is about 8-10 hours for 4Ah battery.

WARNING!

- 1-Charger is for indoor use only.
- 2-If external cables are damaged, they must be replaced by a qualified person in order to avoid mishap.

TESTING DEVICE:

- 1-Remove the pressure regulator from LPG cylinder!
- 2-Press TEST/CONTROL button for 5 seconds.
- 3-You should hear the valve and ignition actuation if the device is working properly.

WARNING!

It is possible to test the device without removing the pressure regulator.
Picture-2As a 120dB blast will occur at the end of the test, use ear plugs during test!.

SAFETY PRECAUTIONS FOR ELECTROLYTE FILLED BATTERIES:

We supply a sealed (dry) type battery with our product. If you use an electrolyte filled battery in future. Please keep in the mind below precautions:

- 1-Charging areas have to be ventilated.
- 2-Do not tip electrolyte filled batteries in any direction over a 55 degree angle.
- 3-Batteries contain sulfuric acid which can cause serious burns.
In case of contact with the acid, wash the area of contact with plenty of water.
In case acid splashes to the eyes, immediately go for a medical check up, after having washed the eyes.
- 4-Before charging a frozen battery, wait until the battery has warmed up to 15 degrees Celcius.



Picture-1



Picture-2

ADJUSTMENTS OF TIME AND SHOTS:

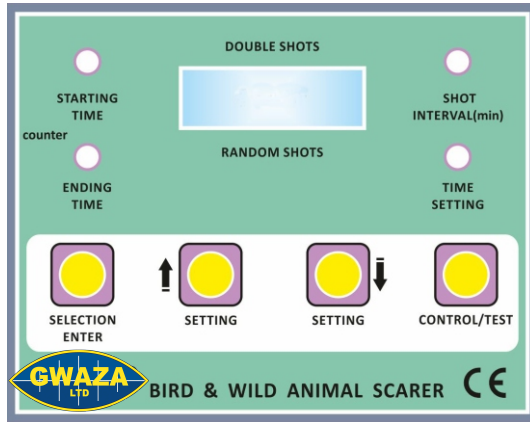

LED LIGHTS AND SELECTION&ENTER BUTTON WILL GUIDE YOU DURING THE ADJUSTMENTS.

TO ADJUST TIME, STARTING TIME, ENDING TIME AND SHOT INTERVAL:

- *Select the value that you want to adjust via SELECTION button, According to your selection, the led light will turn on as red.
- *Use SETTING buttons for new value input.
- *To save the new value and to select following value press ENTER button.

TO ADJUST DOUBLE SHOTS:

- *By using the same procedure above, upper two led lights will turn on for double shots.
- *Enter value **1** for single shot within adjusted interval.
- *Enter value **2** for double shots (second shot one minute later).

TO ADJUST RANDOM (IRREGULAR) SHOT FUNCTION:

- *By the same procedure as above, lower two led lights will turn on for random shots.
- *Enter value **0** for periodical shots within adjusted interval.
- *Enter value **1** for random(irregular) shots within adjusted interval.

WARNING!

COMPLETE ADJUST TOUR TO SAVE ALL VALUES VIA SELECTION/ENTER BUTTON!

TO CONTROL ADJUSTMENTS:

- *Please use CONTROL button to see and to check all adjustments. All inputs will be displayed. It is not possible to change settings displayed in this mode.
- *You will also see counter during the controls. Its indicator is two led lights at left side.

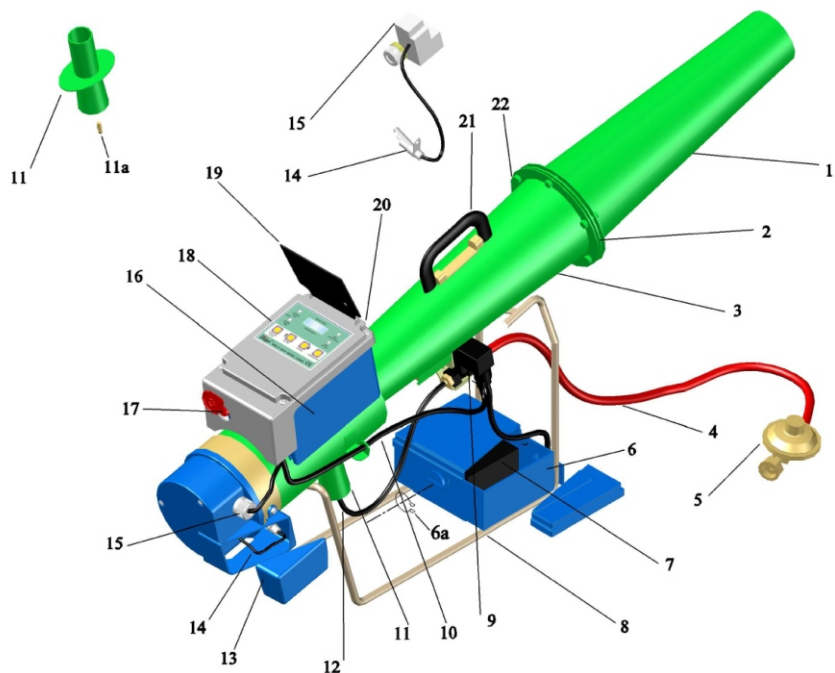

Technical Specifications:

Protection area	:4000 M ² 6000 M ² with tripod
Noise level	:120 dB
Consumption	:30400 shots with 12Kg
Shot interval	:Between 2-30 minutes
Dimensions	:15X97X52 Cm (WxLxH)
Weight	:9,50 Kg incl. battery&charger
Operating tem.	:Between -8°C and +40°C
Battery	:12V
Charger	:220V 6/12V 500 mA
Hose strenght	:10Bar
Pressure regulator	:50 mbar

Part No. Part Name

1.....	Front barrel
2.....	Flange in front barrel
3.....	Rear Barrel
4.....	LPG Hose (inlet)
5.....	Pressure regulator
6.....	Battery box
6A.....	Circlip
7.....	Battery
8.....	Chassis
9.....	Solenoid valve
10.....	Cable (four)
11.....	Gas inlet pipe

Part No. Part Name

11A.....	Nozzle
12.....	Hose (outlet)
13.....	Spark plug cover
14.....	Spark plug
15.....	Igniter
16.....	Control box
17.....	Main power button
18.....	Membran sticker
19.....	Cover of display
20.....	Fuse (in the box)
21.....	Handle
22.....	M6 bolt&nut

Troubleshooting	Probable cause	Remedy
Nothing appears in the display.	1-Battery connection 2-Incorrect battery connection 3-Battery is flat 4-Fuse (No.20)	1-Control socket connection 2-Red socket is “+” pole 3-Charge/replace the battery 4-Control/replace fuse (2.5 amper glass fuse)